

The production, distribution and utilization of this document as well as the communication of its content is prohibited without express authorization is prohibited. Offenders will be held liable for the payment of damages. All rights reserved in the event of the grant of a patent, utility model or design. (DIN ISO 16016)

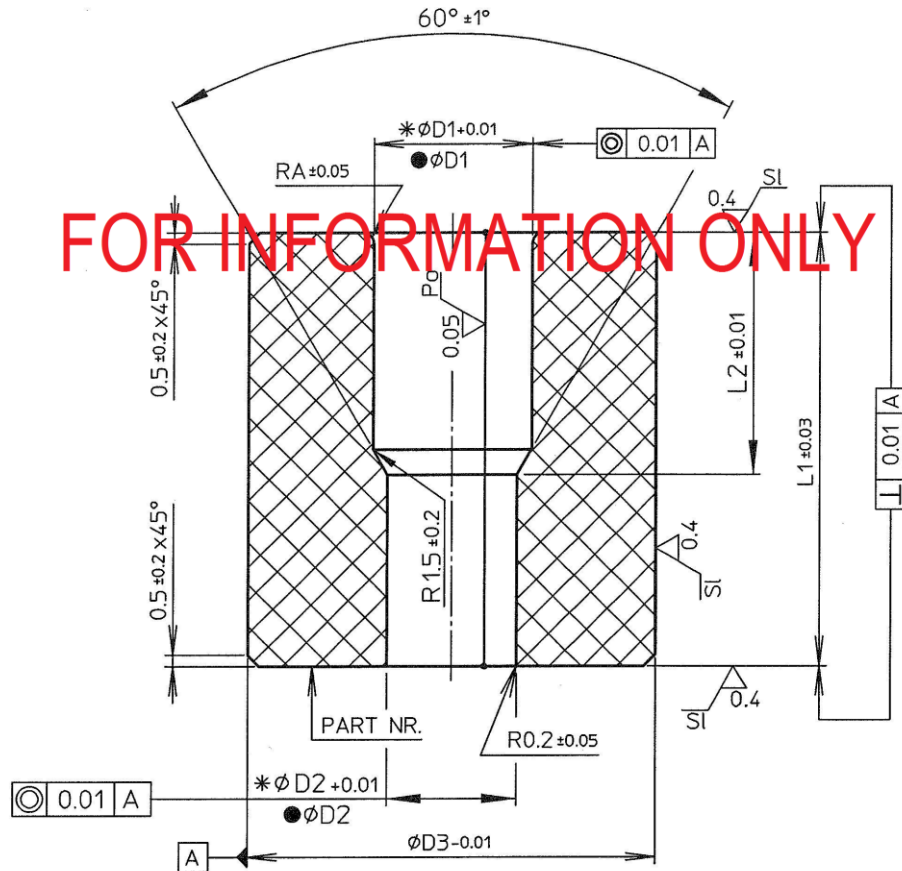

- \* BEFORE PRESSING IN
- AFTER PRESSING IN

269116.01	18.27	18.21	14.86	14.80	38.0	30.0	10.0	0.2
PART NR.	*D1	●D1	*D2	●D2	D3	L1	L2	RA

Machine:	Dim.:	Surf. finish:	Scale:
NH522L17	Mat.: CARBIDE STEEL-HARTMETAL-ALLIAGE DUR G30	3.2	Date: 13-01-17
1	Treatm.:	1 Ra = 10 <sup>-6</sup> CLA	Drawn: B.V.G.
2	Description: PUNTMATRIJS	Drwg. No.:	Size: A4
3	POINTING DIE		Sheet: 1/1
4	KUPPMATRIZE		
5	MATRICE D'APPOINTAGE		

